

(2) 5/16" KEPS NUT



(2) RETAINING WASHER



CAST IN STUDS



SPREADER BAR
CAST 535
ALUMINUM

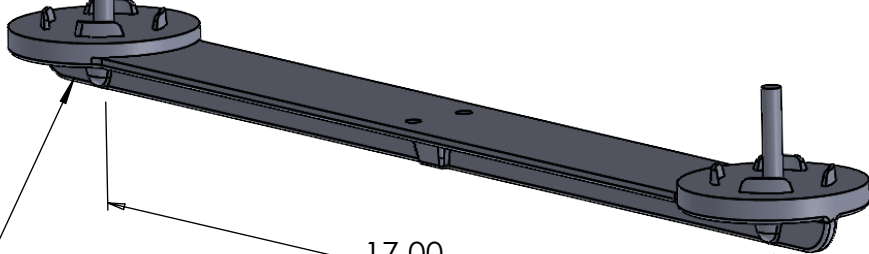

17.00
CTC

NOTES:

1. PLATED STEEL HARDWARE.
2. STAINLESS STEEL HARDWARE AVAILABLE.

THE INFORMATION CONTAINED IN THIS DRAWING IS THE SOLE PROPERTY OF SKYBRACKET. ANY REPRODUCTION IN PART OR WHOLE WITHOUT THE WRITTEN PERMISSION OF SKYBRACKET IS PROHIBITED.



TITLE

2-WAY SPREADER BAR

APPROVALS	BY	DATE
DRAWN	TRC	8/25/23
SALES		
ENGINEERING		

SIZE A	DWG. NO. 12-005	REV -
-----------	--------------------	----------

DO NOT SCALE DRAWING

SCALE: NTS CAD FILE:12-005

SHEET 1 OF 1