

- (1) 3/8-16 THREAD ENDS
- (1) 3/8 FLAT WASHER
- (1) 3/8 SPLIT LOCK WASHER
- (1) 3/8 HEX NUT
- (1) CABLE STOPS

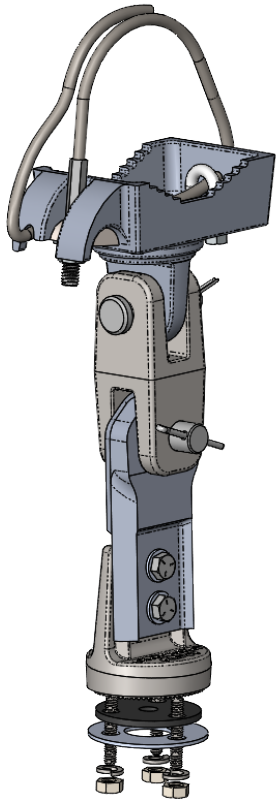

- STAINLESS CABLE
- CAST CABLE CLAMP SADDLE
- (1) 5/16-18 U-BOLT
- (2) 5/16 SPLIT LOCK WASHER
- (2) 5/16 HEX NUT
- CAST CLEVIS
- (2) 5/8 X 2 CLEVIS PIN
- (2) 1/8 STAINLESS COTTER PIN
- HANGER BAR
- (4) 5-16 X 1-1/2 HEX BOLT
- (8) 5/16 FLAT WASHER
- (4) 5/16 SPLIT LOCK WASHER
- (4) 5/16 HEX NUT
- EXTENDER
- TRI-STUD ADAPTER
- (1) RUBBER SEAL
- (1) LOWER RETAINING RING
- (3) 5/16 SPLIT LOCK WASHER
- (3) 5/16 HEX NUT

**PART NUMBER**

**SS-SBC45-PFS-TSA**

CABLE LENGTH

CABLE LENGTH	MAX MAST ARM DIA.
45"	11"
62"	16"
84"	22"

**NOTES:**

1. STAINLESS STEEL FASTENERS
2. AVAILABLE WITH BAND STYLE CLAMP

THE INFORMATION CONTAINED IN THIS DRAWING IS THE SOLE PROPERTY OF SKYBRACKET. ANY REPRODUCTION IN PART OR WHOLE WITHOUT THE WRITTEN PERMISSION OF SKYBRACKET IS PROHIBITED.



TITLE  
**FREE SWINGING  
SIGN MOUNT -TSA -  
CABLE**

APPROVALS	BY	DATE
DRAWN	TRC	3/29/2023
SALES		
ENGINEERING		

SIZE A	DWG. NO. SS-SBC45-PFS-TSA	REV. A
DO NOT SCALE DRAWING		SCALE: NTS CAD FILE: SS-SBC45-PFS-TSA SHEET 1 OF 1